

CITY OF MESQUITE, TEXAS  
NORTHWEST DRIVE SCREENING WALL  
RECONSTRUCTION  
CITY CONTRACT NO. 2025-153

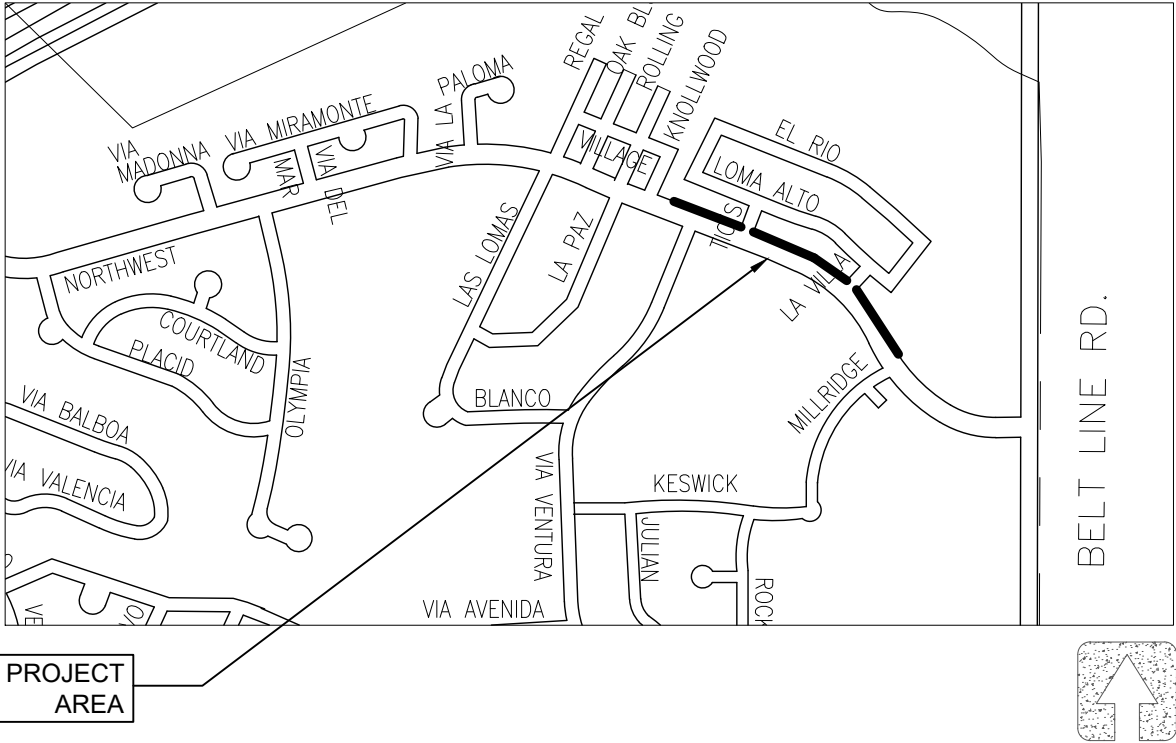

CITY OFFICIALS

DANIEL ALEMAN, JR.	MAYOR
JEFF CASPER	DISTRICT 1
KENNY GREEN	DISTRICT 2
ELIZABETH RODRIGUEZ-ROSS	DISTRICT 3
TANDY BOROUGHS	DISTRICT 4
B.W. SMITH	DISTRICT 5
BRANDON MURDEN	DISTRICT 6
CLIFF KEHELEY	CITY MANAGER
ERIC GALLT P.E.	PUBLIC WORKS DIRECTOR



LOCATION MAP

CITY OF MESQUITE

Public Works Department - Engineering Division  
1515 N. Galloway Ave.  
P.O. Box 850137  
Mesquite, TX 75149  
Ph: 972-216-6955

INDEX OF DRAWINGS

- 1. COVER SHEET
- 2. GENERAL NOTES - TABLE OF QUANTITIES
- 3. CITY OF MESQUITE GENERAL NOTES
- 4. SCREENING WALL PLAN - 1
- 5. SCREENING WALL PLAN - 2
- 6. SCREENING WALL PLAN - 3
- 7. RHINOROCK WALL DETAILS  
PAVING DETAIL SHEET - 1  
PAVING DETAIL SHEET - 3

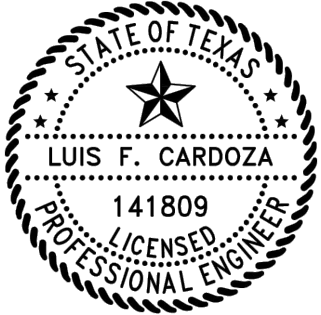

*Luis Cardoza*

6/16/2025



June 2025

GENERAL CONSTRUCTION NOTES

1. IT IS THE CONTRACTOR'S RESPONSIBILITY TO NOTIFY UTILITY COMPANIES (811) & MESQUITE UTILITIES DISPATCH OFFICE (972-216-6973) TO ARRANGE FOR EXACT LOCATIONS AT LEAST 48 HOURS PRIOR TO BEGINNING CONSTRUCTION. UTILITIES SHOWN ON THE PLANS WERE TAKEN FROM THE FIELD SURVEY, AS-BUILTS PROVIDED BY THE CITY AND INFORMATION PROVIDED BY THE UTILITY COMPANIES. THE COMPLETENESS AND THE ACCURACY OF THIS DATA IS NOT GUARANTEED. THE CONTRACTOR IS RESPONSIBLE FOR VERIFYING THE LOCATION OF ALL UNDERGROUND UTILITIES AND PROTECTING THEM FROM DAMAGE DURING CONSTRUCTION.

2. STANDARD DETAILS FOR THIS PROJECT SHALL FIRST APPLY TO CITY OF MESQUITE STANDARD DETAILS AND THEN THOSE SET FORTH IN THE CURRENT STANDARD SPECIFICATIONS FOR PUBLIC WORKS CONSTRUCTION PUBLISHED BY THE NORTH CENTRAL TEXAS COUNCIL OF GOVERNMENTS.

3. CONTRACTOR SHALL COORDINATE WITH THE CITY'S CONSTRUCTION INSPECTOR TO DESIGNATE TREES WITHIN THE CITY AND/OR TXDOT RIGHT OF WAY THAT WILL INTERFERE WITH CONSTRUCTION. THE CONTRACTOR SHALL BE RESPONSIBLE FOR REMOVING AND/OR TRIMMING THE DESIGNATED TREES. IN ADDITION, CONTRACTOR SHALL COORDINATE WITH THE CITY'S CONSTRUCTION INSPECTOR TO DESIGNATE TREES ON PRIVATE PROPERTY THAT WILL INTERFERE WITH CONSTRUCTION. TREES ON PRIVATE PROPERTY SHALL EITHER BE REMOVED OR TRIMMED BY THE CONTRACTOR TO ALLOW FOR CONSTRUCTION AFTER COORDINATION WITH PROPERTY OWNERS.

4. LANDSCAPING PLACED IN THE CITY RIGHT OF WAY BY THE PROPERTY OWNERS WHICH WILL INTERFERE WITH THE CONSTRUCTION DESIGNATED IN THESE PLANS, SHALL BE REMOVED BY THE CITY, ONLY AFTER THE PROPERTY OWNER HAS BEEN NOTIFIED AND GIVEN THE OPPORTUNITY TO RELOCATE THE LANDSCAPING.

5. CONTRACTOR SHALL REPAIR ANY DAMAGE TO EXISTING HOMEOWNER LAWNS, FENCES, FRENCH DRAINS, SHRUBBERY, IRRIGATION SYSTEMS, SHEDS, AC UNITS, AND POOLS CAUSED BY CONSTRUCTION AT HIS EXPENSE. ALL DAMAGED GRASS AREAS ARE TO BE REPLACED WITH SOD OF LIKE KIND.

6. ALL COSTS FOR LABOR AND MATERIALS REQUIRED FOR CONSTRUCTION JOINTS, EXPANSION JOINTS, DOWELED PAVEMENT JOINTS, AND SAWCUT ARE INCIDENTAL TO ALL OTHER BID ITEMS. ALL SAWCUTS OF EXISTING PAVEMENT ARE TO BE FULL-DEPTH.

7. CONTRACTOR SHALL PROVIDE CONSTRUCTION STAKING. CONTRACTOR IS RESPONSIBLE FOR HORIZONTAL AND VERTICAL CONTROL AND GRADES. CONTRACTOR MUST SET STRING LINES FOR SCREENING WALL CONSTRUCTION AND OBTAIN CITY INSPECTOR APPROVAL OF GRADE PRIOR TO SETTING FORMS. THE CONTRACTOR IS RESPONSIBLE TO INSURE THAT STORMWATER RUNOFF IS NOT TRAPPED IN YARDS BY THE CONSTRUCTION OF THE SCREENING WALLS.

8. RIGHT-OF-WAY STAKING SHALL BE PERFORMED BY A PROFESSIONAL SURVEYOR LICENSED IN THE STATE OF TEXAS IN ORDER TO DETERMINE RIGHT-OF-WAY ALONG THE WALL CONSTRUCTION LIMITS. PAYMENT SHALL BE ON A UNIT-PRICE BASIS OF PER LINEAR FOOT OF SCREENING WALL STAKED.

9. BEFORE BEGINNING CONSTRUCTION, THE CONTRACTOR SHALL PREPARE A CONSTRUCTION SEQUENCE SCHEDULE. THE CONSTRUCTION SCHEDULE IS TO BE SUBMITTED TO THE CITY FOR APPROVAL.

10. TRAFFIC CONTROL DEVICE NOTE: CONTACT TRAFFIC ENGINEERING DIVISION, 972-216-6917, AT LEAST 48 HOURS PRIOR TO WORK REQUIRING THE REMOVAL OR RELOCATION OF TRAFFIC SIGNS, TRAFFIC CONTROL EQUIPMENT, OR OTHER TRAFFIC CONTROL APPURTENANCES. CITY WILL REMOVE SIGNS.

11. THE CONTRACTOR SHALL PROVIDE THE CITY ENGINEER WITH A TRAFFIC CONTROL PLAN AT LEAST 48 HOURS BEFORE ANY WORK IN A CITY STREET. TRAFFIC CONTROL MEASURES SHALL CONFORM TO PART VI OF THE 'TEXAS MANUAL ON UNIFORM TRAFFIC CONTROL DEVICES' AND THE CITY OF MESQUITE 'WORK ZONE TRAFFIC CONTROL MANUAL'.

12. THE CONTRACTOR SHALL BE REQUIRED TO PREPARE A PRE-CONSTRUCTION VIDEO OF THE PROJECT LIMITS CLEARLY SHOWING THE LOCATION OF ALL IMPROVEMENTS WITHIN AND ADJACENT TO THE PROJECT AREA. FAILURE TO DOCUMENT THE CONDITION OF EXISTING IMPROVEMENTS MAY RESULT IN THE CONTRACTOR BEING REQUIRED TO REPAIR OR REPLACE DAMAGED PROPERTY OR FACILITIES.

13. CONTRACTOR TO MATCH REMOVED CONNECTING FENCE MATERIAL. BID ITEMS FOR FENCE INCLUDE TOTAL FENCE REPLACEMENT.

14. MATERIAL TESTING SHALL BE PERFORMED BY AN INDEPENDENT TESTING LABORATORY AND PAID FOR BY THE CONTRACTOR, WITH RESULTS FORWARDED TO THE CITY.

15. NO WATER, RAIN SPOTS, WASH, POLY COVERING OR SURFACE MARKING DAMAGE OF ANY KIND WILL BE ACCEPTED. ANY CONCRETE PLACED LATE IN THE DAY MUST BE MANNED AND PROTECTED FROM DAMAGE.

16. ALL EXCESS MATERIAL SHALL BE REMOVED AND DISPOSED OF OFF-SITE.

17. EXISTING R.O.W. SHOWN GRAPHICALLY ON THE PLANS IS FOR INFORMATIONAL PURPOSES ONLY AND NOT TO BE USED FOR DETERMINATION OF PROPERTY LINES.

18. THE CONTRACTOR IS RESPONSIBLE FOR EROSION CONTROL THROUGHOUT CONSTRUCTION. THE FOLLOWING ARE NOT REQUIRED; STABILIZED CONSTRUCTION EXITS, SILT FENCE FOR THE ENTIRE PROJECT LIMITS, AN SWPPP, AN NOI, A CSN, AND A GENERAL PERMIT.

19. ALL AREAS DISTURBED DURING CONSTRUCTION WILL BE SODDED WITH GRASS THAT MATCHES EXISTING LAWN. SODDING AND FERTILIZING SHALL BE DONE IN ACCORDANCE WITH THE N.C.T.C.OG. STANDARD SPECIFICATIONS FOR PUBLIC WORKS CONSTRUCTION (ITEM 202.5). THE CONTRACTOR SHALL MAINTAIN SODDED AREAS FOR A TWO (2) WEEK PERIOD FOLLOWING PLANTING AND/OR UNTIL FINAL ACCEPTANCE OF THE PROJECT BY THE CITY.

TABLE OF QUANTITIES

Item	Description	Units	Sheet			Plan QTY	Bid QTY
			3	4	5		
1	Mobilization (Max 5% of Bid)	LS				1	1
2	Traffic Control and Barricades	LS				1	1
3	Implementation of Erosion Control Devices	LS				1	1
4	Remove Existing Screening Wall including Grade Beam , Mow Strip, Columns & Piers	LF	425	435	290	1150	1200
5	Remove Existing Concrete Sidewalk	SY	230	225	35	490	520
6	Remove Decorative Concrete Footing/Grade Beam & Brick	LS				1	1
7	Remove Tree, 12" Diameter or Greater	EA			1	1	2
8	Trim Existing Trees/Clear Shrubs	LS				1	1
9	Remove, Store & Remount Cast Stone Sign in New Wall	EA	1	1		2	2
10	Remove & Replace Existing Fence (Wood)	LF	60	60	60	180	180
11	Remove & Replace Existing Fence (Metal)	LF			20	20	20
12	Construct 4" Thick Reinforced Concrete Sidewalk	SY	230	225	35	490	520
13	Construct ADA Ramp, Including Limits of Pay Item as Shown on Details and Including Removal and Disposal of Existing Concrete (TYPE D)	EA	1	2	1	4	4
14	Install 6-foot Tall Screening Wall (RHINOROCK)	LF	425	435	290	1150	1200
15	Construct Variable Height Concrete Mow Strip	LF	425	435	290	1150	1200
16	Installation of Sod to Match Existing Turf	SY	370	385	260	1015	1150
17	Right-of-Way & Construction Staking	LS				1	1
18	Install, Maintain and Remove Temp. Const. Chain Link Fence (6-foot Tall) with Privacy Netting	LF	425	415	270	1110	1110
19	Irrigation Repair Allowance	ALW				1	1

NORTHWEST DRIVE SCREENING  
WALL RECONSTRUCTION  
CONTRACT# 2025-153

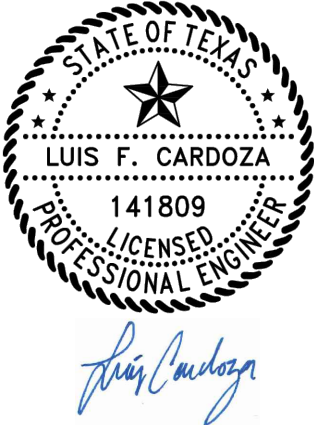







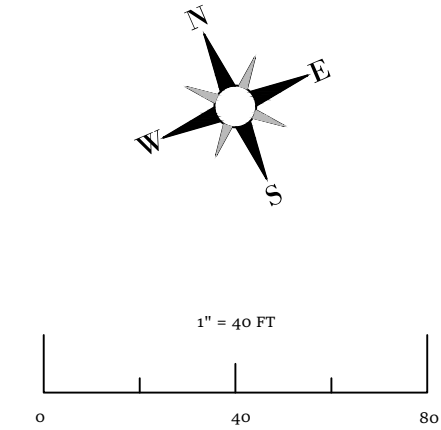

- Proposed Sidewalk
- Proposed Screen Wall
- Photo & Direction
- Water Meter
- Sewer Manhole
- Reducer
- Fire Hydrant
- Existing Valve
- Existing Sewer Line
- Existing Water Line
- Existing Overhead Electricity
- Storm Line

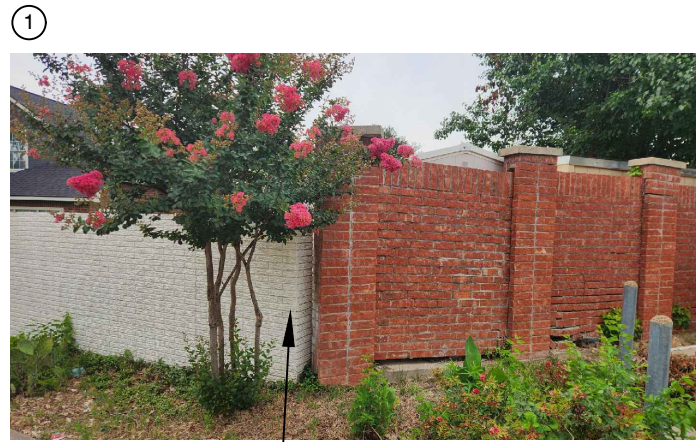

**CAUTION EXISTING UTILITIES!**  
CONTRACTOR TO CALL FOR LOCATES 48 HRS. PRIOR TO BEGINNING CONSTRUCTION. CONTRACTOR SHALL BE RESPONSIBLE FOR REPAIRING UTILITIES DAMAGED DURING CONSTRUCTION

- ALL SCREENING WALLS SHALL COMPLY WITH CITY OF MESQUITE GENERAL DESIGN STANDARDS FOR SCREENING WALLS.
- STATIONING IS ALONG NORTHWEST DRIVE.
- CONTRACTOR SHALL TRIM OR REMOVE EXIST TREES THAT ARE ADJACENT TO PROPOSED WALL & IN CONFLICT WITH CONSTRUCTION. CONTACT CITY INSPECTOR PRIOR TO REMOVING/TRIMMING TREES/SHRUBS
- CONTRACTOR SHALL IDENTIFY LOCATIONS OF EXISTING DRILL SHAFTS TO AVOID THEM WHEN SETTING NEW PIER LOCATIONS AND ADJUST ACCORDINGLY.
- CONTRACTOR SHALL REMOVE & SALVAGE EX. ENTRANCE SIGN & RECESS MOUNT IT ON PROPOSED WALL. LOCATION SHALL BE COORDINATED WITH CITY CONSTRUCTION INSPECTOR.



PUBLIC WORKS  
DEPARTMENT

EXISTING UTILITIES AND UNDERGROUND FACILITIES INDICATED ON THESE PLANS HAVE BEEN LOCATED FROM REFERENCE INFORMATION. IT SHALL BE THE RESPONSIBILITY OF THE CONTRACTOR TO VERIFY BOTH HORIZONTALLY AND VERTICALLY THE LOCATION OF EXISTING UTILITIES AND UNDERGROUND FACILITIES PRIOR TO CONSTRUCTION, TO TAKE THE NECESSARY PRECAUTIONS IN ORDER TO PROTECT ALL FACILITIES ENCOUNTERED. THE CONTRACTOR SHALL PRESERVE AND PROTECT ALL EXISTING UTILITIES FROM DAMAGE DURING CONSTRUCTION.

NORTHWEST DRIVE SCREENING  
WALL RECONSTRUCTION  
CONTRACT# 2025-153

SCREENING WALL PLAN - 1

REVISIONS

SCALE 1" = 40'

DATE: 6/10/2025

DRAWN BY: LC

SHEET: 3

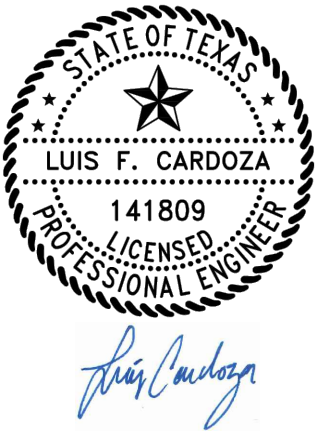



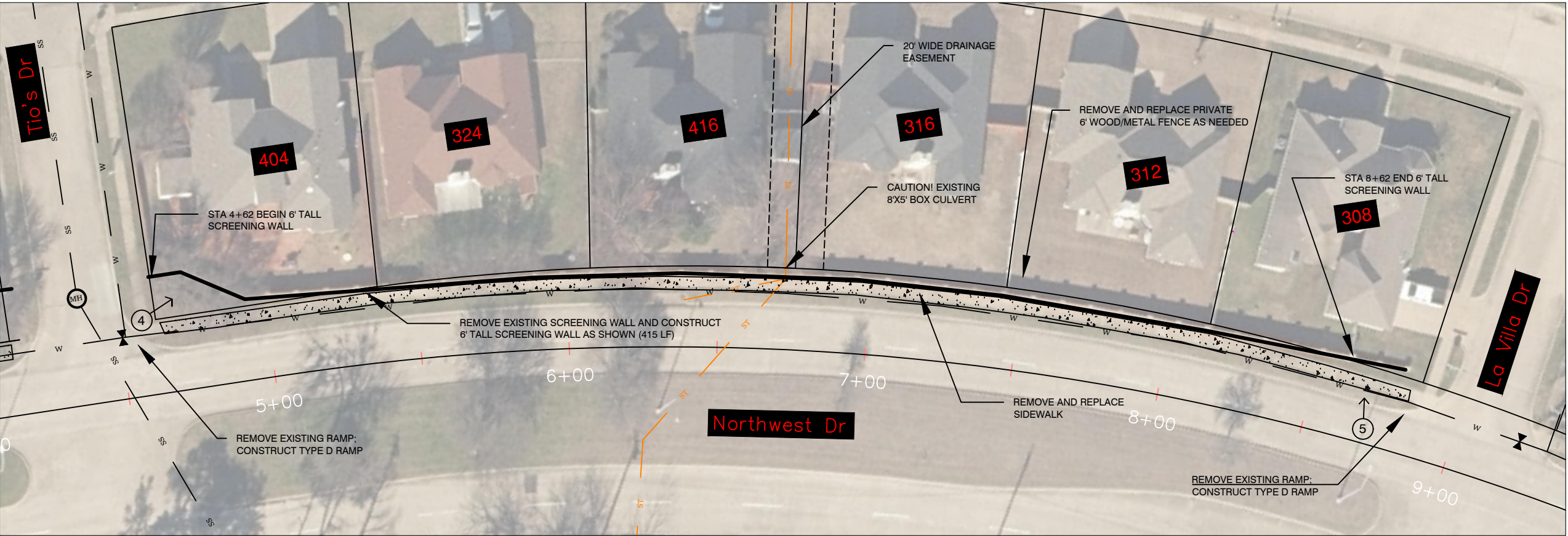

Proposed Sidewalk

Proposed Screen Wall

Photo & Direction Taken

Water Meter

Sewer Manhole

Reducer

Fire Hydrant

Existing Valve

Existing Sewer Line

Existing Water Line

Existing Overhead Electricity

Storm Line



**CAUTION EXISTING UTILITIES!**  
CONTRACTOR TO CALL FOR LOCATES 48 HRS. PRIOR TO BEGINNING CONSTRUCTION. CONTRACTOR SHALL BE RESPONSIBLE FOR REPAIRING UTILITIES DAMAGED DURING CONSTRUCTION

1. ALL SCREENING WALLS SHALL COMPLY WITH CITY OF MESQUITE GENERAL DESIGN STANDARDS FOR SCREENING WALLS.
2. STATIONING IS ALONG NORTHWEST DRIVE.
3. CONTRACTOR SHALL TRIM OR REMOVE EXIST TREES THAT ARE ADJACENT TO PROPOSED WALL & IN CONFLICT WITH CONSTRUCTION. CONTACT CITY INSPECTOR PRIOR TO REMOVING/TRIMMING TREES/SHRUBS
4. CONTRACTOR SHALL IDENTIFY LOCATIONS OF EXISTING DRILL SHAFTS TO AVOID THEM WHEN SETTING NEW PIER LOCATIONS AND ADJUST ACCORDINGLY.
5. CONTRACTOR SHALL REMOVE & SALVAGE EX. ENTRANCE SIGN & RECESS MOUNT IT ON PROPOSED WALL. LOCATION SHALL BE COORDINATED WITH CITY CONSTRUCTION INSPECTOR.



PUBLIC WORKS  
DEPARTMENT

EXISTING UTILITIES AND UNDERGROUND FACILITIES INDICATED ON THESE PLANS HAVE BEEN LOCATED FROM REFERENCE INFORMATION. IT SHALL BE THE RESPONSIBILITY OF THE CONTRACTOR TO VERIFY BOTH HORIZONTALLY AND VERTICALLY THE LOCATION OF EXISTING UTILITIES AND UNDERGROUND FACILITIES PRIOR TO CONSTRUCTION, TO TAKE THE NECESSARY PRECAUTIONS IN ORDER TO PROTECT ALL FACILITIES ENCOUNTERED. THE CONTRACTOR SHALL PRESERVE AND PROTECT ALL EXISTING UTILITIES FROM DAMAGE DURING CONSTRUCTION.

NORTHWEST DRIVE SCREENING  
WALL RECONSTRUCTION  
CONTRACT# 2025-153

SCREENING WALL PLAN - 2

REVISIONS

SCALE 1" = 40'

DATE: 6/10/2025

DRAWN BY: LC

SHEET: 4

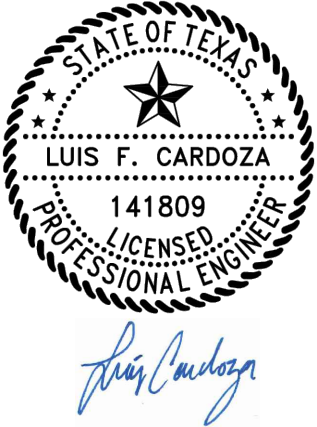



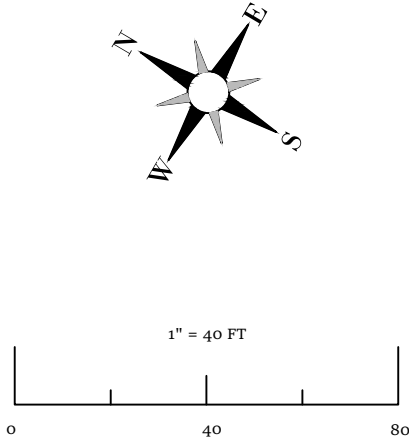
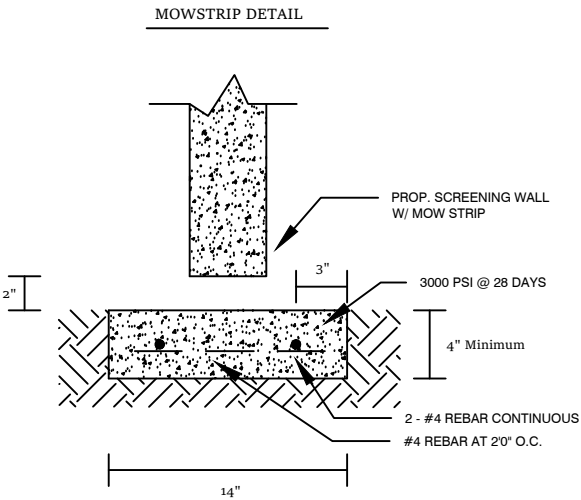
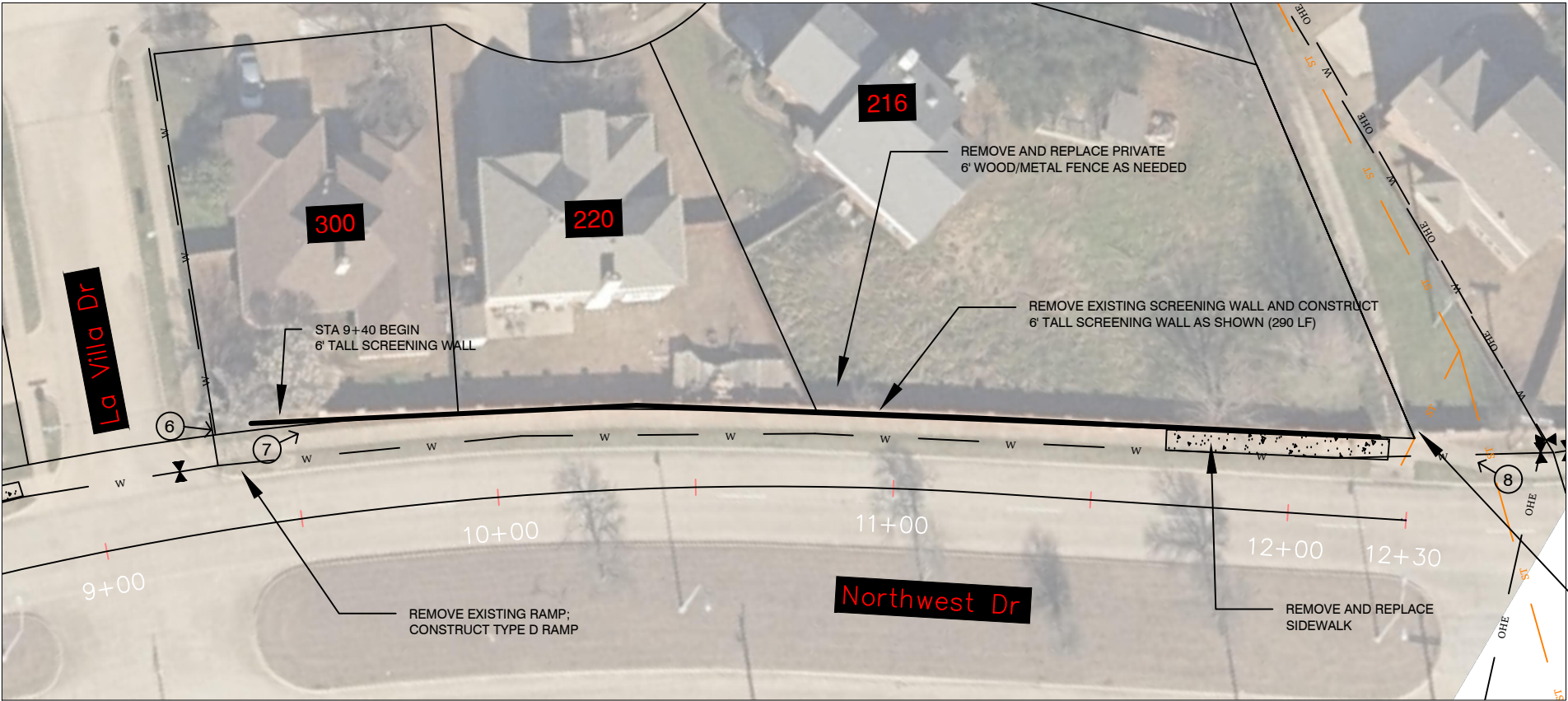

- Proposed Sidewalk
- Proposed Screen Wall
- Photo & Direction
- Water Meter
- Sewer Manhole
- Reducer
- Fire Hydrant
- Existing Valve
- Existing Sewer Line
- Existing Water Line
- Existing Overhead Electricity
- Storm Line

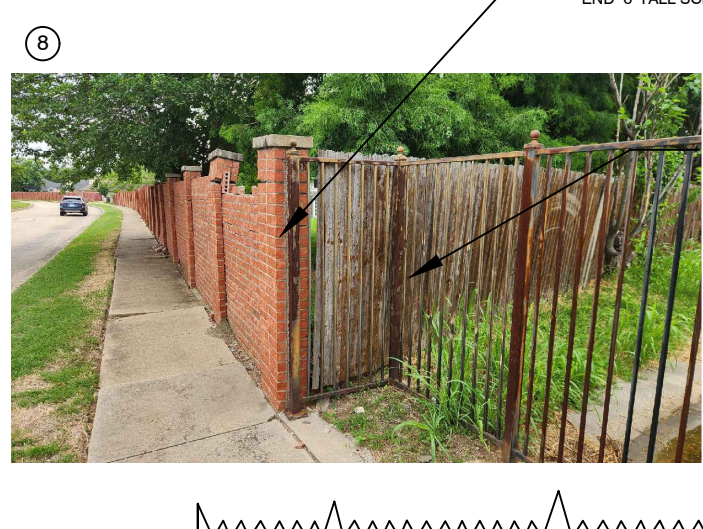

REMOVE AND REPLACE 6' TALL STEEL FENCE AS NEEDED

**CAUTION EXISTING UTILITIES!**  
CONTRACTOR TO CALL FOR LOCATES 48 HRS. PRIOR TO BEGINNING CONSTRUCTION. CONTRACTOR SHALL BE RESPONSIBLE FOR REPAIRING UTILITIES DAMAGED DURING CONSTRUCTION

- ALL SCREENING WALLS SHALL COMPLY WITH CITY OF MESQUITE GENERAL DESIGN STANDARDS FOR SCREENING WALLS.
- STATIONING IS ALONG NORTHWEST DRIVE.
- CONTRACTOR SHALL TRIM OR REMOVE EXIST TREES THAT ARE ADJACENT TO PROPOSED WALL & IN CONFLICT WITH CONSTRUCTION. CONTACT CITY INSPECTOR PRIOR TO REMOVING/TRIMMING TREES/SHRUBS
- CONTRACTOR SHALL IDENTIFY LOCATIONS OF EXISTING DRILL SHAFTS TO AVOID THEM WHEN SETTING NEW PIER LOCATIONS AND ADJUST ACCORDINGLY.
- CONTRACTOR SHALL REMOVE & SALVAGE EX. ENTRANCE SIGN & RECESS MOUNT IT ON PROPOSED WALL. LOCATION SHALL BE COORDINATED WITH CITY CONSTRUCTION INSPECTOR.



PUBLIC WORKS  
DEPARTMENT

EXISTING UTILITIES AND UNDERGROUND FACILITIES INDICATED ON THESE PLANS HAVE BEEN LOCATED FROM REFERENCE INFORMATION. IT SHALL BE THE RESPONSIBILITY OF THE CONTRACTOR TO VERIFY BOTH HORIZONTALLY AND VERTICALLY THE LOCATION OF EXISTING UTILITIES AND UNDERGROUND FACILITIES PRIOR TO CONSTRUCTION, TO TAKE THE NECESSARY PRECAUTIONS IN ORDER TO PROTECT ALL FACILITIES ENCOUNTERED. THE CONTRACTOR SHALL PRESERVE AND PROTECT ALL EXISTING UTILITIES FROM DAMAGE DURING CONSTRUCTION.

NORTHWEST DRIVE SCREENING  
WALL RECONSTRUCTION  
CONTRACT# 2025-153

SCREENING WALL PLAN - 3

REVISIONS	
SCALE 1" = 40'	DRAWN BY: LC
DATE: 6/10/2025	SHEET: 5

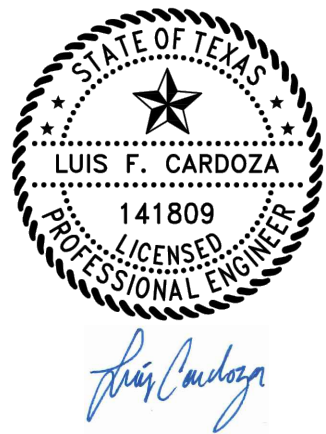



Technical Specification of Rhinorock Panel

-Weight of 72"x102" panel:

280 lbs

-Thickness of panel:

4.5"

-EPS foam core thickness:

2.5-3.75"

-GFRC Shell thickness:

0.3-0.5"

-% glass fibre:

3.5-4%

-compressive strength GFRC:

3500psi

-wind load design of panel:

v 3 sec 115mph Exp B

-due to nature of cast concrete, 3/8" diameter or less imperfections or bug holes may be present

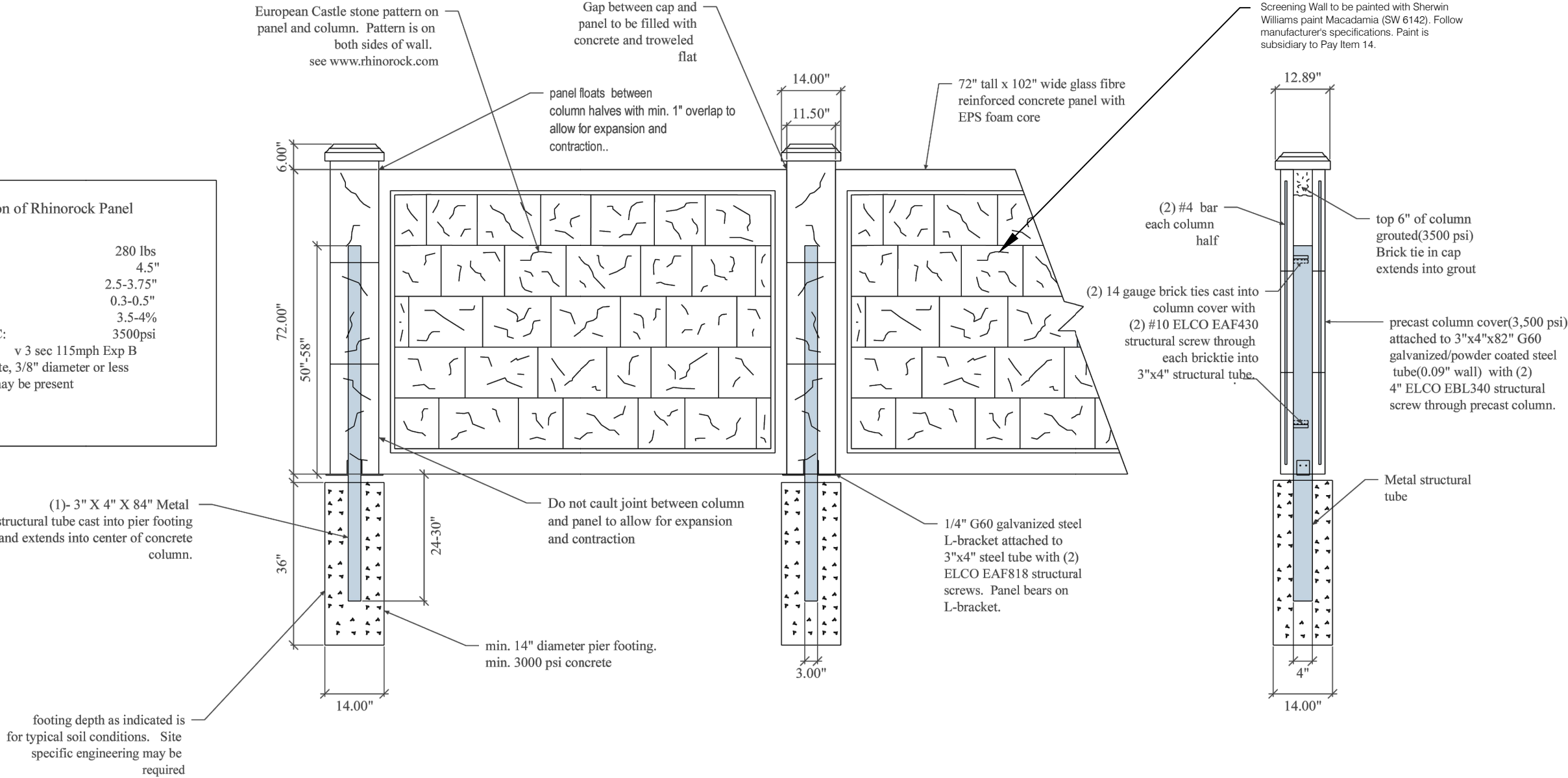

**A RHINOROCK WALL ELEVATION**

**Rhinorock™**  
(801) 735-8877

**B RHINOROCK COLUMN DETAIL**



PUBLIC WORKS  
DEPARTMENT

EXISTING UTILITIES AND UNDERGROUND FACILITIES INDICATED ON THESE PLANS HAVE BEEN LOCATED FROM REFERENCE INFORMATION. IT SHALL BE THE RESPONSIBILITY OF THE CONTRACTOR TO VERIFY BOTH HORIZONTALLY AND VERTICALLY THE LOCATION OF EXISTING UTILITIES AND UNDERGROUND FACILITIES PRIOR TO CONSTRUCTION, TO TAKE THE NECESSARY PRECAUTIONS IN ORDER TO PROTECT ALL FACILITIES ENCOUNTERED. THE CONTRACTOR SHALL PRESERVE AND PROTECT ALL EXISTING UTILITIES FROM DAMAGE DURING CONSTRUCTION.

NORTHWEST DRIVE SCREENING  
WALL RECONSTRUCTION  
CONTRACT# 2025-153

RHINOROCK WALL DETAILS

REVISIONS	
SCALE 1" = 40'	DRAWN BY: LC
DATE: 6/10/2025	SHEET: 6

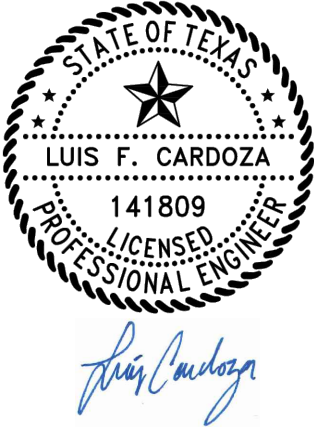

Per Table

Coat Half Dowel Length

Refer to Table for Thickness

Hot Poured Rubber Joint Sealing Compound (1/2" Min. Depth)

Extra #4 Bars to Align Dowels

Dowel Basket Must Be Used In Street, Alley and Firelane Paving

Expansion Material, Redwood, No Gap Is Allowed Between Material And Ground

Expansion Cap

T/2

**EXPANSION JOINT**

SMOOTH DOWEL BARS				
COMMERCIAL DRIVEWAY, STREET, ALLEY & FIRE LANE PAVING THICKNESS (IN.)	DIAMETER (IN.)	LENGTH (IN.)	SPACING (IN.)	EXPANSION JOINT THICKNESS (IN.)
< 6"	#4 (1/2")	24	12	1/2"
6" TO < 8"	#5 (5/8")	30	18	3/4"
8" TO < 10"	#6 (3/4")	30	18	3/4"
> 10"	#8 (1")	30	18	3/4"

SIDEWALK, RESIDENTIAL DRIVEWAY AND TRAIL THICKNESS (IN.)				
DIAMETER (IN.)	LENGTH (IN.)	SPACING (IN.)	EXPANSION JOINT THICKNESS (IN.)	
4" TO 6"	#4 (1/2")	24	12	1/2"

NOTES:

- EXPANSION CAP FOR DOWELS SHALL HAVE AN INSIDE DIAMETER OF 1/16" GREATER THAN THAT OF THE DOWEL AND BE DESIGNED TO PROVIDE FREE MOVEMENT OF THE DOWEL BAR.
- EXPANSION CAP TO FIT DOWEL MIN. 2" EMBEDMENT AND MIN. 1-1/4" CLEARANCE FROM THE CLOSED END OF THE SLEEVE TO THE DOWEL.
- EXPANSION JOINTS SHALL BE INSTALLED AT A MAXIMUM DISTANCE OF 600 FEET, AND AT STREET INTERSECTIONS, RADI, PCS AND PTS OR AS OTHERWISE DIRECTED. NO EXPANSION JOINT SHALL FALL IN A DRIVEWAY APPROACH OR INLET.
- EXPANSION MATERIAL SHALL BE REDWOOD MATERIAL UNLESS OTHERWISE APPROVED.
- DOWEL BARS TO BE PLACED PARALLEL TO PAVEMENT AT SPACING AND LENGTHS PER TABLE. CENTERED ON EXPANSION MATERIAL. ONE SIDE OF DOWEL BAR SHALL BE COATED IN THIN FILM OF GREASE OR OTHER APPROVED DE-BONDING MATERIAL. WHERE DRILLING OF DOWEL BARS IS REQUIRED, IT SHALL BE DONE BY AN APPROVED MECHANICAL RIG.
- EXPANSION JOINTS SHALL NOT BE PLACED AT PAVEMENT GRADE BREAKS.

MESQUITE TEXAS Real. Texas. Service.

Public Works

EXPANSION JOINTS

GENERAL DESIGN STANDARDS STANDARD DETAILS

SCALE: N.T.S. REVISION DATE: 05/17/2022 SHEET: P-1

Keyway Required for Handpour (Optional for Slipform Paving)

Vertical Saw-cut 1/4" Wide (Min.), Filled w/Hot Poured Rubber Joint Sealing Compound

T/4 or 2" Whichever Is Less

Proposed Concrete (First Pour)

Proposed Concrete (Second Pour)

Overlap Steel Reinforcing 30 Bar Diameters & Tie

**LONGITUDINAL CONSTRUCTION JOINT**

See Table

Vertical Saw-cut 1/4" Wide (Min.), Filled w/Hot Poured Rubber Joint Sealing Compound

T/4 or 2" Whichever Is Less

Proposed Paving

Existing Pavement

or Proposed Pavement (Second Pour)

Deformed Reinforcing Bar

Epoxy if Drilled Into Existing Pavement L/2

T = Pavement Thickness

L = Dowel Length

**TRANSVERSE CONSTRUCTION JOINT**

DEFORMED REINFORCING BARS			
COMMERCIAL DRIVEWAY, STREET, ALLEY & FIRE LANE PAVING THICKNESS (IN.)	DIAMETER (IN.)	LENGTH (IN.)	SPACING (IN.)
< 6"	#4 (1/2")	24	12
6" TO < 8"	#5 (5/8")	30	18
8" TO < 10"	#6 (3/4")	30	18
> 10"	#8 (1")	30	18

SIDEWALK, RESIDENTIAL DRIVEWAY AND TRAIL THICKNESS (IN.)			
DIAMETER (IN.)	LENGTH (IN.)	SPACING (IN.)	
4" TO 6"	#4 (1/2")	24	12

NOTES:

- DOWEL BARS TO BE PLACED PARALLEL TO PAVEMENT AT SPACING AND LENGTHS PER TABLE. WHERE DRILLING OF DOWEL BARS IS REQUIRED, IT SHALL BE DONE BY AN APPROVED MECHANICAL RIG.
- TRANSVERSE CONSTRUCTION JOINT CAN BE USED AS LONGITUDINAL CONSTRUCTION JOINT IN APPLICATIONS WHERE NEW PAVEMENT IS TO BE CONSTRUCTED OR RECONSTRUCTED NEXT TO OLD PAVEMENT.
- IF DOWELING INTO EXISTING PAVEMENT THAT IS 8" OR LESS IN THICKNESS, USE TRANSVERSE CONSTRUCTION JOINT DETAIL.

MESQUITE TEXAS Real. Texas. Service.

Public Works

CONSTRUCTION JOINTS

GENERAL DESIGN STANDARDS STANDARD DETAILS

SCALE: N.T.S. REVISION DATE: 05/17/2022 SHEET: P-2

**Sidewalk & Trails:**  
Vertical Saw-Cut 1/8" wide (Min.). No Joint Filling Required.

**Streets & Alley Pavement:**  
Vertical Sawcut-1/4" Wide (Min.). Hot poured Rubber Joint sealing compound\*

Backer Rod\*

T/4 or 2" Whichever Is Less

T/2

**SAWED CONTRACTION JOINT**

3/4"

Hot Poured Rubber Joint Sealing Compound\* (1/2" Min.)

T/2

Expansion Material, Redwood (No Gap Between Expansion Material and Ground)

**ISOLATION JOINT**

MESQUITE TEXAS Real. Texas. Service.

Public Works

SAWED CONTRACTION & ISOLATION JOINT

GENERAL DESIGN STANDARDS STANDARD DETAILS

SCALE: N.T.S. REVISION DATE: 05/20/2019 SHEET: P-3

Contraction Joint, Typ.

Sawn Contraction Joints Max. Spacing 20' O.C., Typ.

Back of Curb

Expansion Joint, Typ.

Back of Curb

**TYPICAL STREET JOINTING**

NOTE:

- ALL CONCRETE PLACEMENT SHALL END IN A JOINT, AN EXPANSION JOINT OR A CONCRETE HEADER
- SAWED CONTRACTION JOINTS ARE REQUIRED AT CENTER LINE AND LANE LINE IN ANY STREET PAVEMENT WIDTH GREATER THAN 22.5 FEET (BACK TO BACK OF CURB)
- EXPANSION JOINTS SHALL BE AT A MAXIMUM DISTANCE OF 600 FEET AND STREET INTERSECTION, PCS AND PTS OR AS OTHERWISE DIRECTED. NO EXPANSION JOINT SHALL FALL IN AN APPROACH OR INLET.

Expansion Joint @ End of Radius

Isolation Joint Through Curb

Radius per Intersection Details

Full Depth Sawcut

Back of Curb

Install Undercut Concrete Header

18"

**EXISTING CONCRETE STREET TO NEW CONCRETE STREET TEE INTERSECTION**

MESQUITE TEXAS Real. Texas. Service.

Public Works

STREET JOINTING

GENERAL DESIGN STANDARDS STANDARD DETAILS

SCALE: N.T.S. REVISION DATE: 05/20/2019 SHEET: P-4

Isolation Joints

#4 @ 18" Center; Longitudinally Bent Down

For Undercut Header, Contractor shall hand-dig to expose underside of pavement

9"

16"

3 ~ #4 Bars, Lap 15"

T/2

**CONCRETE HEADER**

T = Pavement Thickness, Not Less than Street Pavement Depth or 8", whichever is greater

Sawcut Asphalt to Undamaged Clean Edge (Min 18" from Concrete)

18"

4" or Existing Pavment Thickness, Whichever Is Greater HMAc Type D; Apply Tack Coat Prior to HMAc

Full Depth Sawcut

T/2

Min 6" Thick, Compacted Recycled Concrete Flexible Base

Thickened Edge, Refer to Detail

**CONCRETE TO ASPHALT HEADER**

NOTES:

- CONCRETE HEADERS SHALL BE CONTINUOUS ALONG EXISTING OR PHASED PAVEMENT WHEN ADJACENT TO THE NEW PAVEMENT. ADDITIONAL LOCATIONS CAN BE SHOWN ON THE PLANS OR AT THE DISCRETION OF THE CITY ENGINEER.

MESQUITE TEXAS Real. Texas. Service.

Public Works

TYPICAL HEADERS

GENERAL DESIGN STANDARDS STANDARD DETAILS

SCALE: N.T.S. REVISION DATE: 05/20/2019 SHEET: P-5

#4 Bar, Typ.

Pavement Reinforcement

Bent #4 at 18" OC

14"

T

T = PAVEMENT THICKNESS, NOT LESS THAN STREET PAVEMENT DEPTH OR 8", WHICHEVER IS GREATER.

MESQUITE TEXAS Real. Texas. Service.

Public Works

THICKENED CONCRETE EDGE

GENERAL DESIGN STANDARDS STANDARD DETAILS

SCALE: N.T.S. REVISION DATE: 05/20/2019 SHEET: P-6

6"

3" R

1:3 Batter

1.5" R

#4 @ 18" OC

T = Pavement Thickness, Not Less than Street Pavement Depth or 8", whichever is greater

30"

**CURB AND GUTTER (HMAC PAVEMENT)**

6"

3" R

1:3 Batter

1.5" R

#4 @ 18" OC

18"

18" Long, #8 Bar @ 18" OC; Dowel 9" into Exist Pavement, set in Epoxy

**CURB AND GUTTER (CONCRETE PAVEMENT - FOR RECONSTRUCTION)**

6"

3" R

1:3 Batter

1.5" R

#4 @ 18" OC

T

Reinforcement shall match Street Paving

**INTEGRAL CURB**

11.5"

1"

6" High Curb

#4 @ 18" OC

T

Reinforcement shall match Street Paving

**LAYDOWN CURB**

NOTES:

- INTEGRAL CURB SHALL BE USED ON ALL NEW STREETS.
- ANY HONEYCOMB PRESENT ON BACKSIDE OF CURB SHALL BE FILLED IN.

MESQUITE TEXAS Real. Texas. Service.

Public Works

TYPICAL CURB & GUTTER

GENERAL DESIGN STANDARDS STANDARD DETAILS

SCALE: N.T.S. REVISION DATE: 07/22/2019 SHEET: P-7

4:1 Max

1' Typ.

Typ. 1.5% Slope, Max 2%

#4 @ 12" OCEW

5' Min

Min 50:1 Max 4:1

**TYPICAL SECTION (OFFSET FROM CURB) PREFERRED OPTION**

Match Exist Grade

4:1 Max

Typ. 1.5% Slope, Max 2%

#4 @ 12" OCEW

6' Min

8"

Drill and Epoxy in Place 8" Long Deformed #3 @ 24" OC

**TYPICAL SECTION (ADJACENT TO CURB) - ONLY WITH PERMISSION OF CITY ENGINEER**

Per Table (A)

Contraction Joint

Expansion Joint

Per Table (B)

**PLAN VIEW**

Type	Width	Thickness	Contraction Joint (A)	Expansion Joint (B)
Sidewalk	Min. 5' < 8'	4"	10' Spacing Tooled Joint	120' Max.
Trail - Hike & Bike	≥ 8'	6"	15' Spacing Sawcut	300' Max

NOTES:

- EXPANSION JOINTS SHALL BE PLACED AT MAXIMUM INTERVALS PER TABLE AND SHALL ALSO BE PLACED AT EACH LOT LINE.
- EXPANSION JOINTS REQUIRED BETWEEN AND ABUTTING CONCRETE PAVEMENT. NO EXPANSION JOINT IS REQUIRED BETWEEN SIDEWALK AND ADJACENT STREET CURB. FOR EXPANSION JOINTS ON DRIVEWAYS, REFER TO P-26 THROUGH P-29.
- ALL SIDEWALKS SHALL HAVE POSITIVE DRAINAGE.

MESQUITE TEXAS Real. Texas. Service.

Public Works

PEDESTRIAN FACILITIES

GENERAL DESIGN STANDARDS STANDARD DETAILS

SCALE: N.T.S. REVISION DATE: 05/17/2022 SHEET: P-8



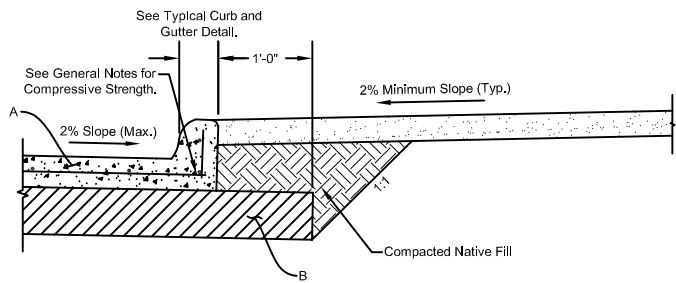

Classification	Minimum Pavement Thickness (A)	Minimum Subgrade Thickness (B)	Minimum Bar; Maximum Spacing Reinforcing Steel
Local	6"	6" Lime Stabilized at 8% (Or 6" Crushed Concrete)	#4 @ 18" C.C.
Collector	8"	8" Lime Stabilized at 8% (Or 8" Crushed Concrete)	#4 @ 18" C.C.
Fire Lane	Per Fire Lane Detail		
Alleys	Per Typical Alley Detail		
Arterials	Per Engineering Design Manual Section 2.11		#4 @ 18" C.C.

NOTE:  
CRUSHED CONCRETE SHALL MEET TXDOT SPECIFICATIONS, ITEM 247, TYPE D, GRADE 1 OR 2 WITH TRIAX TX 140 GEOGRID (OR APPROVED EQUAL).

**MESQUITE TEXAS**  
Real. Texas. Service.

Public Works

**CONCRETE PAVEMENT  
DETAIL  
TYPICAL SECTION**

GENERAL DESIGN STANDARDS  
STANDARD DETAILS

SCALE: N.T.S.	SHEET: P-14
REVISION DATE: 05/20/2019	

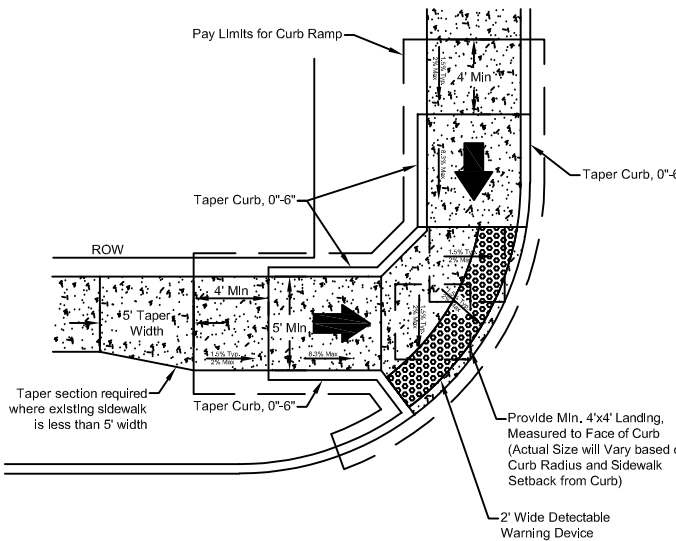

- NOTES:
- ALL PEDESTRIAN ELEMENTS, INCLUDING CURB RAMPS, SHALL COMPLY WITH THE PROPOSED ACCESSIBILITY GUIDELINES FOR PEDESTRIAN FACILITIES IN THE PUBLIC RIGHT-OF-WAY (PROWAG), PUBLISHED BY THE ARCHITECTURAL AND TRANSPORTATION COMPLIANCE BOARD ON JULY 16, 2011, 36 CFR PART 1190 OR ITS FINAL ADOPTED GUIDELINES.
  - ALL PEDESTRIAN PATHS SHALL HAVE TYPICAL 1.5% (PERCENT), MAXIMUM 2% (PERCENT) CROSS SLOPE.
  - DETAILS ARE REPRESENTATION OF INFORMATION FROM PROWAG AND ARE INTENDED TO PROVIDE GUIDANCE. IT IS THE RESPONSIBILITY OF THE DESIGN PROFESSIONAL AND THE CONTRACTOR TO ENSURE THAT ALL RAMPS CONSTRUCTED MEET THE REQUIREMENTS OF PROWAG.

**MESQUITE TEXAS**  
Real. Texas. Service.

Public Works

**CURB RAMP  
TYPE C**

GENERAL DESIGN STANDARDS  
STANDARD DETAILS

SCALE: N.T.S.	SHEET: P-18
REVISION DATE: 09/08/2020	

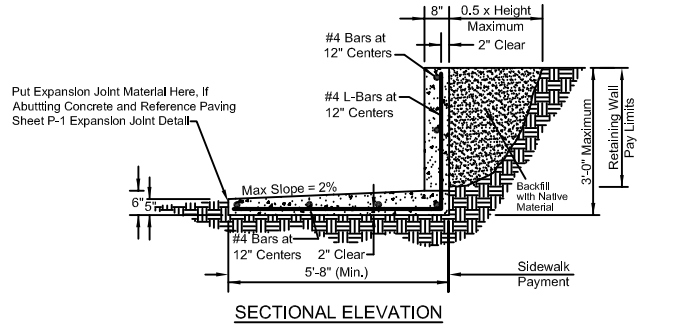

- NOTES:
- EXPOSED FACE OR WALL SHALL HAVE FORM LINER SIKA GREENSTREAK #439, SIERRA DRYSTACK OR SYMONS #F3170575, #3170503 STANDARD DRY STACK OR AS DIRECTED BY THE CITY ENGINEER. FORM LINER IS REQUIRED FOR WALL 6" (SIX INCHES) IN HEIGHT AND OVER.
  - MINIMUM COMPRESSIVE DESIG STRENGTH OF THE CONCRETE SHALL BE 4,000 PSI AT 28 DAYS, 6 SACK MINIMUM CEMENT CONTENT.
  - MINIMUM GRADE OF REINFORCING STEEL IS TO BE ASTM A-615, GRADE 60.
  - ALL DISTANCES TO REINFORCING STEEL REFER TO CLEAR CONCRETE COVER OVER REINFORCING STEEL UNLESS NOTED OTHERWISE.
  - MAXIMUM REINFORCING STEEL LAP IS TO BE THIRTY (30) BAR DIAMETERS.
  - MAXIMUM SPACING OF EXPANSION JOINTS SHALL BE 120' FEET. AN EXPANSION JOINT SHALL BE PLACED AT EACH PROPERTY LINE. EXPANSION JOINTS SHALL BE CONTINUOUS THROUGH WALL AND ASSOCIATED SIDEWALK.
  - ALL EXPOSED EDGES SHALL HAVE A 1/4" INCH CHAMFER.
  - SIDEWALK WIDTH SHOWN IS MINIMUM WIDTH. CONSULT PAVING PLANS FOR THE CLEAR SIDEWALK WIDTH.

**MESQUITE TEXAS**  
Real. Texas. Service.

Public Works

**CONCRETE SIDEWALK  
WITH RETAINING WALL**

GENERAL DESIGN STANDARDS  
STANDARD DETAILS

SCALE: N.T.S.	SHEET: P-15
REVISION DATE: 05/20/2019	

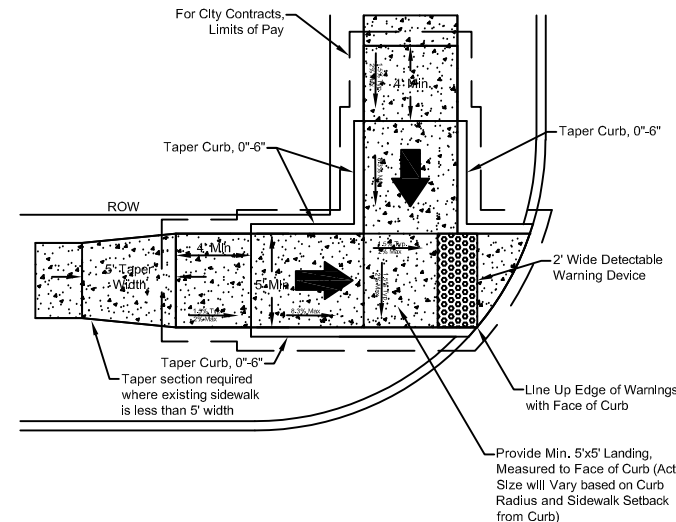

- NOTES:
- ALL PEDESTRIAN ELEMENTS, INCLUDING CURB RAMPS, SHALL COMPLY WITH THE PROPOSED ACCESSIBILITY GUIDELINES FOR PEDESTRIAN FACILITIES IN THE PUBLIC RIGHT-OF-WAY (PROWAG), PUBLISHED BY THE ARCHITECTURAL AND TRANSPORTATION COMPLIANCE BOARD ON JULY 16, 2011, 36 CFR PART 1190 OR ITS FINAL ADOPTED GUIDELINES.
  - ALL PEDESTRIAN PATHS SHALL HAVE TYPICAL 1.5% (PERCENT), MAXIMUM 2% (PERCENT) CROSS SLOPE.
  - DETAILS ARE REPRESENTATION OF INFORMATION FROM PROWAG AND ARE INTENDED TO PROVIDE GUIDANCE. IT IS THE RESPONSIBILITY OF THE DESIGN PROFESSIONAL AND THE CONTRACTOR TO ENSURE THAT ALL RAMPS CONSTRUCTED MEET THE REQUIREMENTS OF PROWAG.

**MESQUITE TEXAS**  
Real. Texas. Service.

Public Works

**CURB RAMP  
TYPE D**

GENERAL DESIGN STANDARDS  
STANDARD DETAILS

SCALE: N.T.S.	SHEET: P-19
REVISION DATE: 09/08/2020	

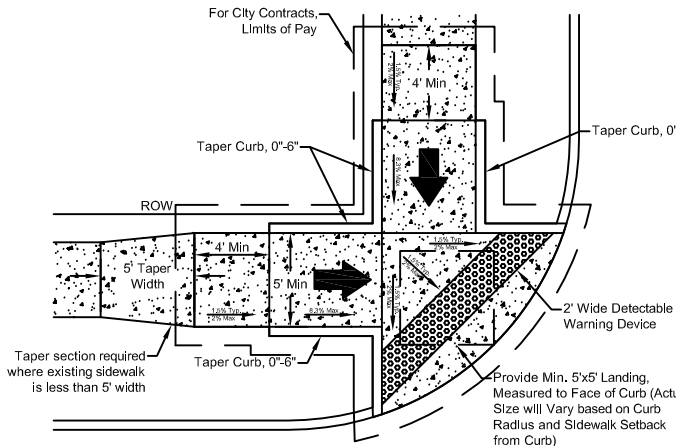

- NOTES:
- ALL PEDESTRIAN ELEMENTS, INCLUDING CURB RAMPS, SHALL COMPLY WITH THE PROPOSED ACCESSIBILITY GUIDELINES FOR PEDESTRIAN FACILITIES IN THE PUBLIC RIGHT-OF-WAY (PROWAG), PUBLISHED BY THE ARCHITECTURAL AND TRANSPORTATION COMPLIANCE BOARD ON JULY 16, 2011, 36 CFR PART 1190 OR ITS FINAL ADOPTED GUIDELINES.
  - ALL PEDESTRIAN PATHS SHALL HAVE TYPICAL 1.5% (PERCENT), MAXIMUM 2% (PERCENT) CROSS SLOPE.
  - DETAILS ARE REPRESENTATION OF INFORMATION FROM PROWAG AND ARE INTENDED TO PROVIDE GUIDANCE. IT IS THE RESPONSIBILITY OF THE DESIGN PROFESSIONAL AND THE CONTRACTOR TO ENSURE THAT ALL RAMPS CONSTRUCTED MEET THE REQUIREMENTS OF PROWAG.

**MESQUITE TEXAS**  
Real. Texas. Service.

Public Works

**CURB RAMP  
TYPE A**

GENERAL DESIGN STANDARDS  
STANDARD DETAILS

SCALE: N.T.S.	SHEET: P-16
REVISION DATE: 09/08/2020	

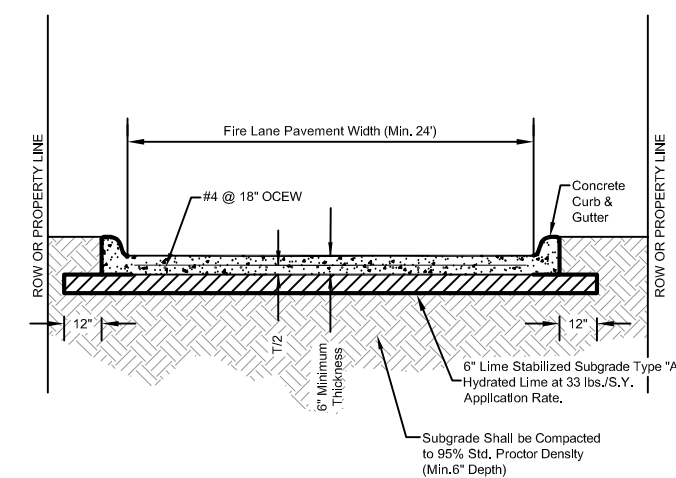

- NOTES:
- REFER TO DETAIL FOR EXPANSION JOINT AND CONTRACTION JOINT, FOR SPACING, ETC. OF JOINTS.
  - WHERE A CURB IS USED, THE REQUIRED CLEARANCE SHALL BE MEASURED FROM THE CURB FACE TO ANY PERMANENT TRAFFIC OBSTACLE.
  - CONCRETE SHALL BE 4,000 PSI AT 28 DAYS, 6 (SIX) SACK MIX MINIMUM. REFER TO PAVING GENERAL NOTES FOR ADDITIONAL REQUIREMENTS.
  - 6" (SIX INCH) LIME STABILIZED SUBGRADE MAY BE SUBSTITUTED BY EITHER ADDITIONAL 2" (TWO INCHES) OF CONCRETE PAVING OR 6" (SIX INCHES) RECYCLED CONCRETE FLEXIBLE BASE (PER TXDOT ITEM NO. 247, TYPE 1, GRADE D).
  - ALL DIMENSIONS ARE FACE TO FACE OF CURB, WHERE A FIRE LANE DEAD ENDS AND EXCEEDS 150' (FEET) LENGTH, A HAMMERHEAD OR CUL-DE-SAC PER DETAIL P14-B MUST BE PROVIDED FOR THE FIRE TRUCK TO TURN AROUND.
  - FOR FIRE LANE PAVEMENT WIDTH, REFER TO 2015 INTERNATIONAL FIRE CODE APPENDIX D 103 AND CITY ORDINANCES 4486 AND 4490 FOR AMENDMENTS.

**MESQUITE TEXAS**  
Real. Texas. Service.

Public Works

**FIRE LANE  
PAVING**

GENERAL DESIGN STANDARDS  
STANDARD DETAILS

SCALE: N.T.S.	SHEET: P-20
REVISION DATE: 05/20/2019	

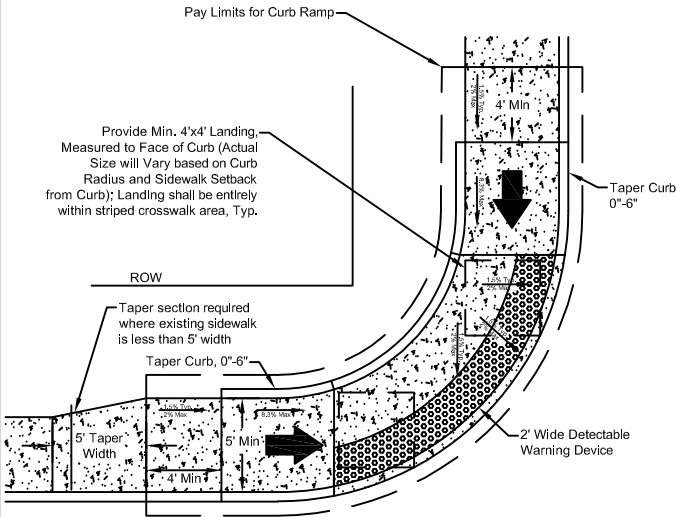

- NOTES:
- ALL PEDESTRIAN ELEMENTS, INCLUDING CURB RAMPS, SHALL COMPLY WITH THE PROPOSED ACCESSIBILITY GUIDELINES FOR PEDESTRIAN FACILITIES IN THE PUBLIC RIGHT-OF-WAY (PROWAG), PUBLISHED BY THE ARCHITECTURAL AND TRANSPORTATION COMPLIANCE BOARD ON JULY 16, 2011, 36 CFR PART 1190 OR ITS FINAL ADOPTED GUIDELINES.
  - ALL PEDESTRIAN PATHS SHALL HAVE TYPICAL 1.5% (PERCENT), MAXIMUM 2% (PERCENT) CROSS SLOPE.
  - DETAILS ARE REPRESENTATION OF INFORMATION FROM PROWAG AND ARE INTENDED TO PROVIDE GUIDANCE. IT IS THE RESPONSIBILITY OF THE DESIGN PROFESSIONAL AND THE CONTRACTOR TO ENSURE THAT ALL RAMPS CONSTRUCTED MEET THE REQUIREMENTS OF PROWAG.

**MESQUITE TEXAS**  
Real. Texas. Service.

Public Works

**CURB RAMP  
TYPE B**

GENERAL DESIGN STANDARDS  
STANDARD DETAILS

SCALE: N.T.S.	SHEET: P-17
REVISION DATE: 09/08/2020	

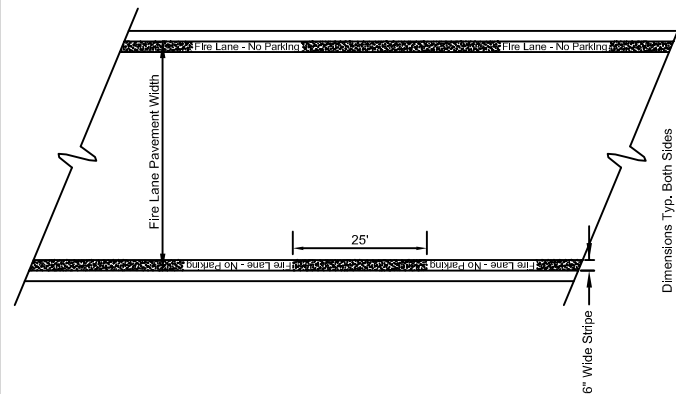

- NOTES:
- LETTERING SHALL BE "FIRE LANE - NO PARKING" OR "NO PARKING - FIRE LANE" WITH 4" (FOUR INCH) WHITE LETTERS.
  - WHERE CURB IS AVAILABLE, THE STRIPING SHALL BE ON THE VERTICAL FACE OF CURB.

**MESQUITE TEXAS**  
Real. Texas. Service.

Public Works

**FIRE LANE  
STRIPING**

GENERAL DESIGN STANDARDS  
STANDARD DETAILS

SCALE: N.T.S.	SHEET: P-21
REVISION DATE: 05/20/2019	