

HAMPTON INN AT MESQUITE
CONFERENCE CENTER AND EXHIBIT HALL

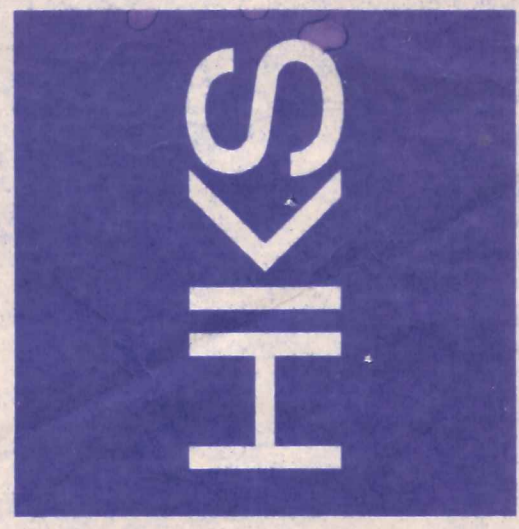

HKS Inc., Architects/Engineers/Planners
2001 LBJ Freeway, Suite 2000
Dallas, Texas 75241-7485
Tel: 214-259-5599

Job No: 5665/5763



6/14/97

24 JUNE 98
05 MARCH 98
28 JULY 1997
ADDENDUM #4

REVISIONS:
DATE: ISSUED FOR BID AND PERMIT

SHEET TITLE:
ROOF PLAN

SHEET NO:
A5.01

- NOTES:**
1. PROVIDE A MINIMUM R-30 INSULATION VALUE FOR B.U. ROOF SYSTEM.
 2. ROOF DRAIN ELEVATIONS LOCAL TO THE ROOF SURFACE. OVERLAP DRAIN ARE LOCATED 2" ABOVE THE ROOF DRAIN ELEVATION.
 3. PROVIDE A MINIMUM R-30 INSULATION VALUE FOR B.U. ROOF SYSTEM.
 4. PROVIDE A MINIMUM R-30 INSULATION VALUE FOR B.U. ROOF SYSTEM.
 5. PROVIDE A MINIMUM R-30 INSULATION VALUE FOR B.U. ROOF SYSTEM.

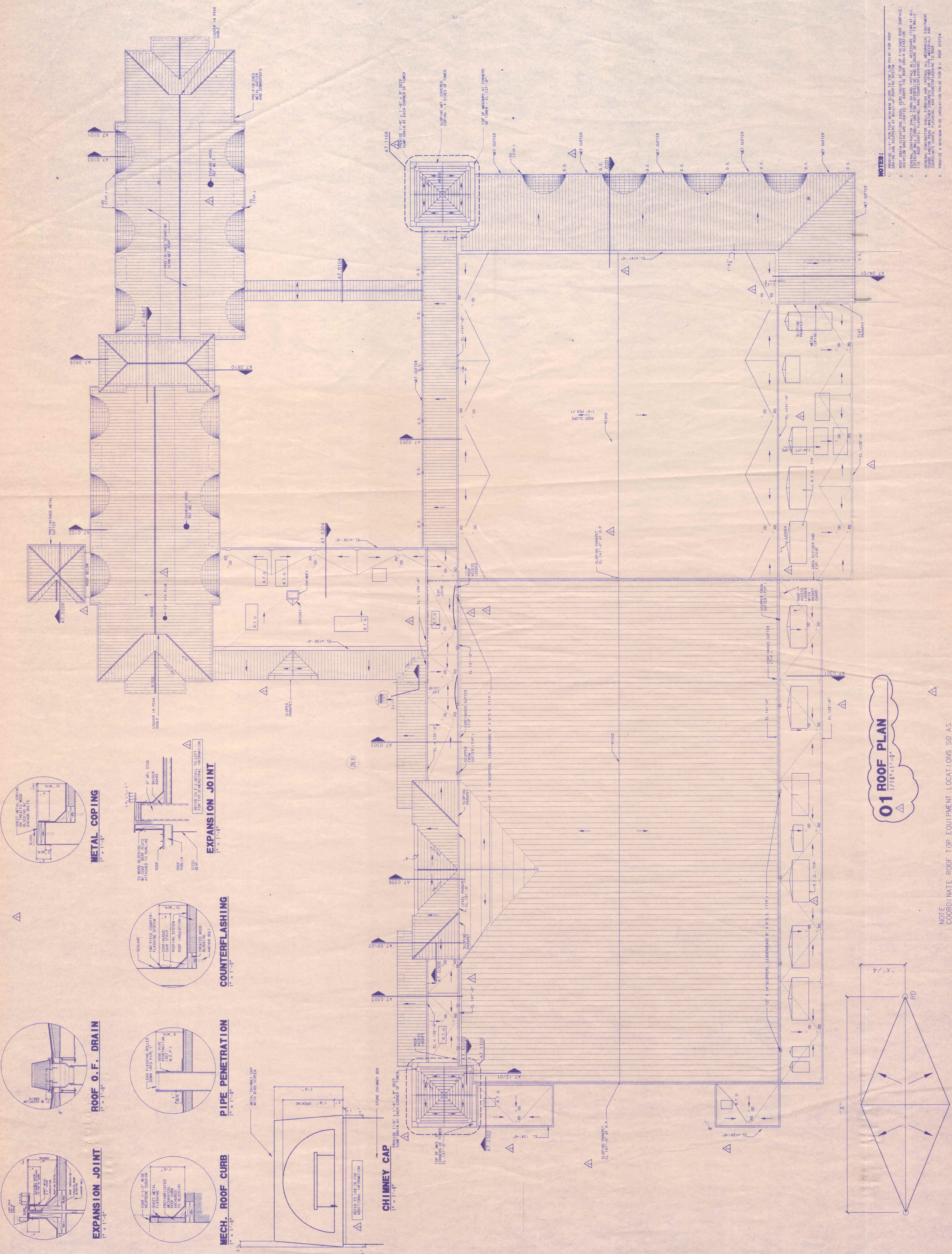

01 ROOF PLAN
1/16" = 1'-0"

NOTE:
COORDINATE ROOF TOP EQUIPMENT LOCATIONS SO AS NOT TO INTERFERE WITH THE LOCATIONS OF ROOF VALLEYS. ANY EQUIPMENT CURB OBSTRUCTING A VALLEY MUST BE FABRICATED TO ALLOW WATER TO PASS THRU.

CRICKET GEOMETRY DIAGRAM

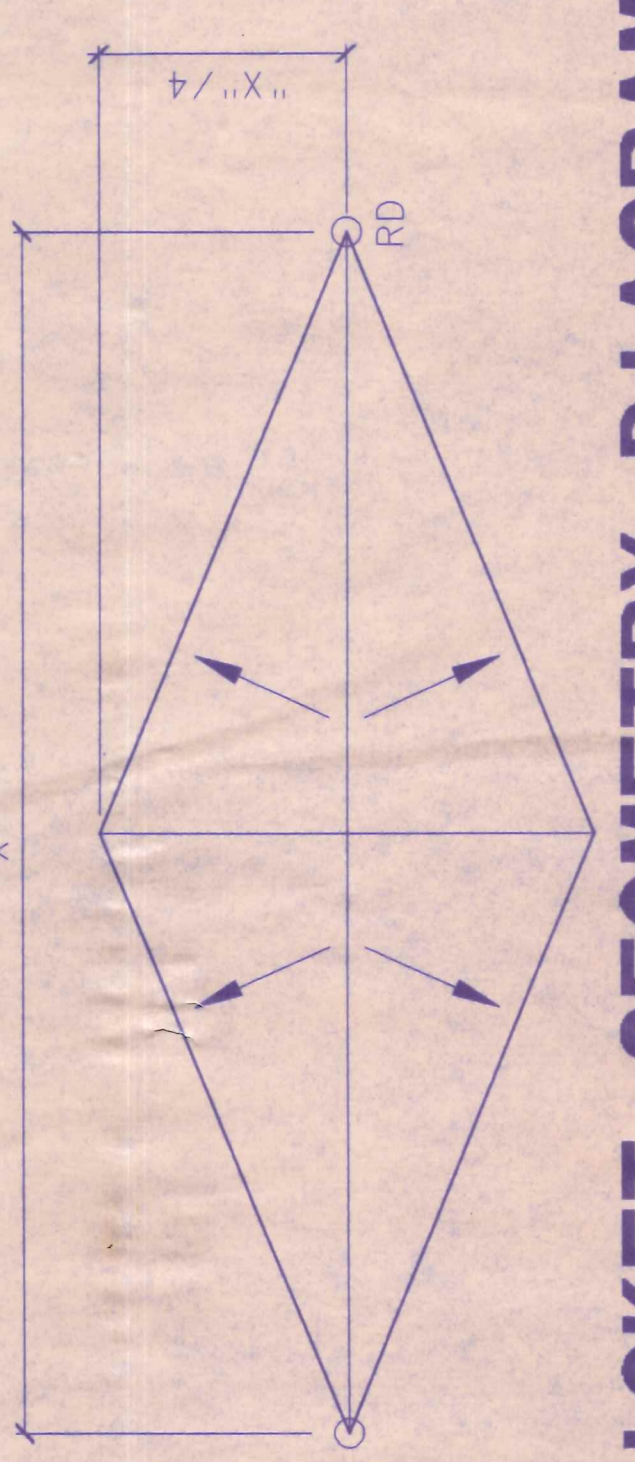

File:	
Plot date:	24 JUN 98