

ORDINANCE NO. 2929

AN ORDINANCE OF THE CITY OF MESQUITE, TEXAS, DEANNEXING THE TRACT OF LAND DESCRIBED IN EXHIBIT "A"; REPEALING ALL ORDINANCES IN CONFLICT HEREWITH TO AND ONLY TO SUCH EXTENT AS SAME ARE IN CONFLICT AND PROVIDING THAT ALL ORDINANCES AND ACTS OF THE CITY OF MESQUITE TO THE EXTENT NOT IN CONFLICT HEREWITH SHALL REMAIN IN FULL FORCE AND EFFECT; PROVIDING THAT SAID ORDINANCE SHALL BE EFFECTIVE FROM AND AFTER DATE OF PASSAGE; AND DECLARING AN EMERGENCY.

WHEREAS, in accordance with the Agreement between the City of Mesquite and Town of Sunnyvale to apportion overlapping extra-territorial jurisdiction it is necessary for the City of Mesquite to deannex certain territory; and

WHEREAS, there are no inhabitants of said territory; and

WHEREAS, no capital expenditures for improvements have been made in said territory;

NOW, THEREFORE, BE IT ORDAINED BY THE CITY COUNCIL OF THE CITY OF MESQUITE, TEXAS:

SECTION 1. That the territory described in Exhibit "A" is hereby deannexed and excluded from the territorial limits of the City of Mesquite, Texas, for all purposes from and after the effective date of this ordinance and publication thereof.

SECTION 2. That all ordinances of the City of Mesquite in conflict with the provisions of this ordinance be, and the same are, hereby repealed, and all other ordinances of the City of Mesquite not in conflict with the provisions of this ordinance shall remain in full force and effect.

SECTION 3. The deannexation of this property is necessary to effect the boundary agreement apportioning extra-territorial jurisdiction between the Cities of Mesquite and Sunnyvale, thus creating an urgency and an emergency for the preservation of the welfare of the citizens of the City of Mesquite and requires that this ordinance shall take effect immediately after passage and publication of said ordinance, as the law in such cases provides.

DULY PASSED AND APPROVED by the City Council of the City of Mesquite,
Texas, on the 18th day of October, 1993.



Cathye Ray
Mayor

ATTEST:

APPROVED:



Lynn Prugel
City Secretary



B.J. Smith
City Attorney

00219

Exhibit "A"

**FIELD NOTES FOR DE-ANNEXATION OF 10-FOOT STRIP
TRIPP AND JOBSON ROADS**

BEGINNING at a point in the corporate limits of the City of Mesquite, Texas, said point being the point of intersection of the east right-of-way line of Belt Line Road and the south right-of-way line of Tripp Road;

THENCE easterly along the south right-of-way line of Tripp Road to a point being the northeast corner of Abstract 960;

THENCE southerly along the east line of Abstract 960 to a point in the north right-of-way line of US Highway 80 East;

THENCE westerly along the north right-of-way line of US Highway 80 East to a point which is 10 feet west of the east line of Abstract 960;

THENCE northerly along a line that is at all times 10 feet perpendicularly distant from and parallel at 10 feet to the east boundary line of Abstract 960 to a point 10 feet south of the south right-of-way line of Tripp Road;

THENCE westerly along a line that is at all times 10 feet perpendicularly distant from and parallel at 10 feet to the south right-of-way line of Tripp Road to a point in the east right-of-way line of Belt Line Road which is 10 feet south of the south right-of-way line of Tripp Road;

THENCE northerly along the east right-of-way of Belt Line Road a distance of 10 feet to the point of beginning.

00220

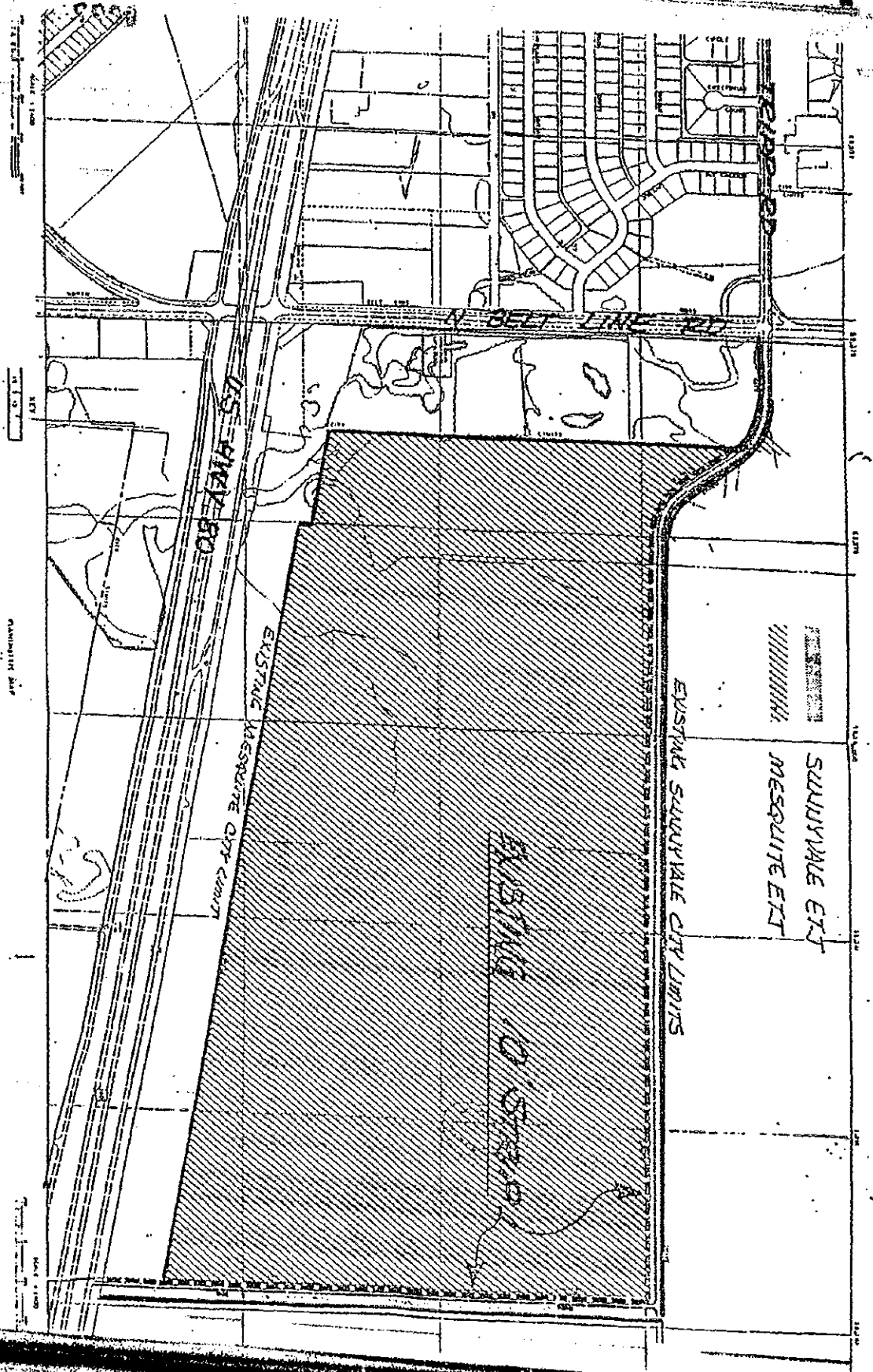

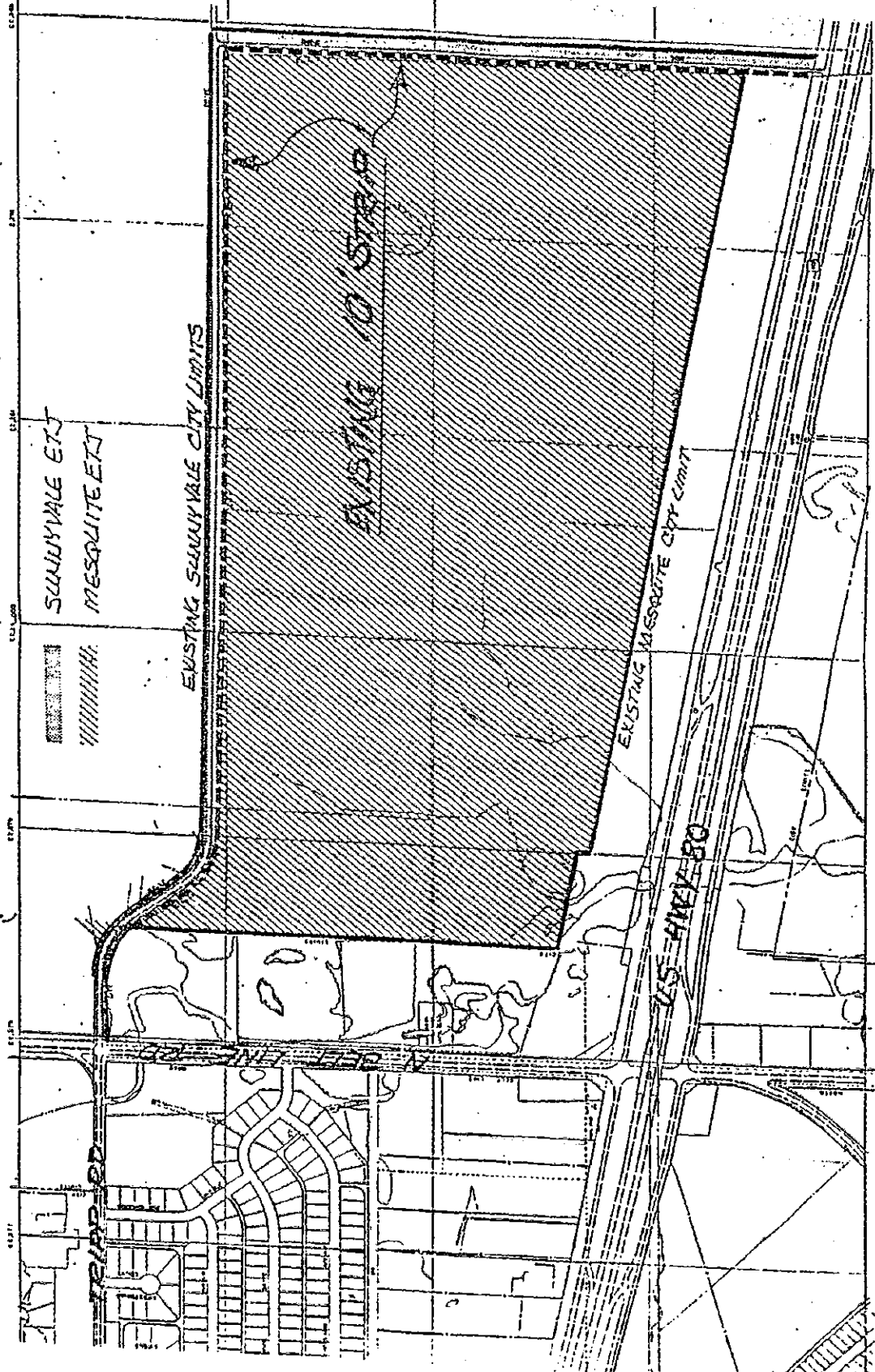

SUNNYVALE EXT
MESQUITE EXT

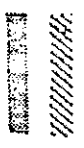

EXISTING SUNNYVALE CITY LIMITS

EXISTING 10' STRIP

EXISTING MESQUITE CITY LIMIT

US HWY 80

PLANNING MAP

00220